

171221 - 15

KEY PLAN

171221 - 16
171221 - 17
171221 - 18
171221 - 19
171221 - 20

171221 - 15A

POLLUTION PREVENTION NOTES:

1. SITE MANAGEMENT PROPOSALS ARE INTENDED TO ENSURE PROTECTION AGAINST SURFACE WATER AND GROUNDWATER POLLUTION, SILTATION AND EROSION.
2. SUITABLE DRAINAGE CONTROL MEASURES SHOULD BE IN PLACE AT ALL TIMES TO PREVENT CONVEYANCE OF SIGNIFICANT VOLUMES OF SILT TO OFF SITE RECEIVING WATERCOURSES.
3. SILT WATER CAN ARISE FROM DEWATERING EXCAVATIONS, EROSION OF EXPOSED/DISTURBED GROUND, TEMPORARY STOCKPILES, PLANT AND WHEEL WASH, SITE ROAD TRACKS, AND SIGNIFICANCE OF EXISTING FIELD DRAINAGE AND DITCHES.

DISCHARGES:

1. WATER CONTAINING SILT WILL NOT BE PUMPED DIRECTLY TO ANY NATURAL WATERCOURSE. ALL DISCHARGES TO BE MADE OVER OPEN GROUND OR INTO EXISTING FIELD DRAIN WITH SILT TRAP A MINIMUM 20M FROM NEAREST WATERCOURSE UNLESS OTHERWISE STATED.
2. NO EXCAVATED MATERIAL IS TO BE STORED WITHIN ANY SURFACE WATER BUFFER ZONE.
3. PUMPED WATER WILL BE DIRECTED INTO TRACK SIDE DITCHES AND TREATED IN SETTLEMENT PONDS AND VEGETATION SWALES PRIOR TO FLOW AND DISCHARGE.
4. DIVERSION OF CLEAN WATER FROM EXCAVATIONS / OR OVER-PUMPING IN FIELD DRAINAGE/DITCHES/STREAMS WILL BE COMPLETED IN A MANNER THAT DOES NOT CAUSE SCOUR OR EROSION AT ANY POINT OF DIVERSION/DISCHARGE. THIS WILL BE DONE BY REDUCING THE FLOW VELOCITIES OR BY USE OF SPLASH PLATES, AND OTHER SIMILAR DISCHARGE CONTROLS.
5. VEGETATION WILL NOT BE STRIPPED FROM EXISTING FIELD DRAINAGE/DITCHES UNLESS ABSOLUTELY NECESSARY.

EXCAVATIONS:

1. WHERE DEEP EXCAVATIONS ARE PROPOSED CUT-OFF DRAINS WILL BE USED TO REDUCE THE AMOUNT OF SURFACE WATER ENTERING THE EXCAVATION. THIS WILL BE THE CASE AROUND TURBINE BASE EXCAVATIONS.

EXPOSED GROUND & STOCKPILES:

1. THE AMOUNT OF EXPOSED GROUND AND TEMPORARY STOCKPILES OPEN AT ANY ONE TIME WILL BE MINIMISED, AS FAR AS PRACTICABLE.

SILT TRAPS:

1. USE OF TRACK SIDE SWALES WITH CHECK DAMS, AND/OR FILTRATION CHECK DAMS WILL REDUCE SILT IN RUNOFF WATER AS REQUIRED.
2. CHECK DAMS TO BE INSPECTED AND CLEANED REGULARLY.

REFUELLING:

1. REFUELLING OF MOBILE PLANT WILL BE COMPLETED IN DESIGNATED REFUELLING AREAS ONLY, PREFERABLY ON AN IMPERMEABLE SURFACE AND AWAY FROM FIELD DRAINS / DITCHES AND WATERCOURSES / WATERBODIES.
2. SPILL KITS AND DRIP TRAYS WILL BE AVAILABLE ON SITE FOR USE AS REQUIRED.

CONCRETE:

1. CARE WILL BE TAKEN WHEN COMPLETING CONCRETE WORKS ON SITE TO ENSURE NO DISCHARGE OCCURS.
2. CONCRETE WASH WATER, AND WASTE CONCRETE WILL BE MANAGED APPROPRIATELY ON SITE.

IF WATER POLLUTION IS IDENTIFIED THE FOLLOWING STEPS WOULD BE ADHERED TO:

STOP - WORK IN THE IMMEDIATE AREA SHOULD BE STOPPED AND THE SOURCE OF THE POLLUTION IDENTIFIED.

CONTAIN - THE SOURCE OF THE POLLUTION SHOULD BE RAISED USING A SUITABLE METHOD. NATURAL WATERCOURSES SHOULD BE TEMPORARILY DIVERTED AROUND THE SOURCE OF POLLUTION.

NOTIFY - THE RELEVANT AUTHORITIES (SITE MANAGER / FISHERIES / NPWS / LOCAL AUTHORITY ETC) SHOULD BE NOTIFIED IMMEDIATELY TO ENSURE THAT MEASURES CAN BE IMPLEMENTED DOWNTHEAM TO PROTECT FISHERIES AND OTHER SENSITIVE AREAS.

MITIGATION / DRAINAGE CONTROLS AVAILABLE FOR USE ACROSS THE SITE

MANAGEMENT TYPE	DESCRIPTION OF SUDS DRAINAGE CONTROL METHODS
AVOIDANCE CONTROLS:	<ol style="list-style-type: none"> 1) APPLICATION OF 50M BUFFER ZONES TO NATURAL WATERCOURSES WHERE POSSIBLE 2) APPLICATION OF 10M BUFFER ZONES TO MAIN DRAINS WHERE POSSIBLE
SOURCE CONTROLS:	<ol style="list-style-type: none"> 1) USE OF UPSTREAM INTERCEPTOR DRAINS AND DOWNTHEAM COLLECTOR DRAINS / OVERSIZED SWALES, VEGETATION, DIVERSION DRAINS, FLUMES AND GULCHET PIPES 2) EROSION AND VELOCITY CONTROL MEASURES SUCH AS: <ol style="list-style-type: none"> a) SAND BAGS b) OYSTER BAGS FILLED WITH GRAVEL c) FILTER FABRICS d) AND OTHER SIMILAR/EQUIVALENT OR APPROPRIATE SYSTEMS 3) VEGETATION STRIPPS 4) COVERING STOCKPILES
IN-LINE CONTROLS:	<ol style="list-style-type: none"> 1) INTERCEPTOR DRAINS, VEGETATION, OVERSIZED SWALES/COLLECTOR DRAINS 2) EROSION AND VELOCITY CONTROL MEASURES SUCH AS: <ol style="list-style-type: none"> a) SAND BAGS b) OYSTER BAGS FILLED WITH GRAVEL c) FILTER FABRICS d) STRAW BALES e) FLOW LIMITERS f) WEIRS OR BAPPLERS g) AND/OR OTHER SIMILAR/EQUIVALENT OR APPROPRIATE SYSTEMS 3) SILT FENCES, FILTER FABRICS 4) IN STREAM SEDIMENTS 5) COLLECTION SUMPS, TEMPORARY SUMPS, PUMPING SYSTEMS 6) ATTENUATION LAGOONS 7) SLOTTED TRAPS, STILLING / SETTLEMENT PONDS
WATER TREATMENT CONTROLS:	<ol style="list-style-type: none"> 1) TEMPORARY SUMPS 2) TEMPORARY STORAGE LAGOONS 3) SEDIMENT TRAPS, STILLING / SETTLEMENT PONDS 4) PROPRIETARY SETTLEMENT SYSTEMS SUCH AS SILTTRUSTERS, AND/OR OTHER SIMILAR/EQUIVALENT OR APPROPRIATE SYSTEMS 5) SALT DEWATERING BAGS
OUTFALL CONTROLS:	<ol style="list-style-type: none"> 1) LEVELSPREADERS 2) BUFFERED OUTFALLS 3) VEGETATION FILTERS 4) SALT DEWATERING BAGS 5) FLOW LIMITERS AND WEIRS

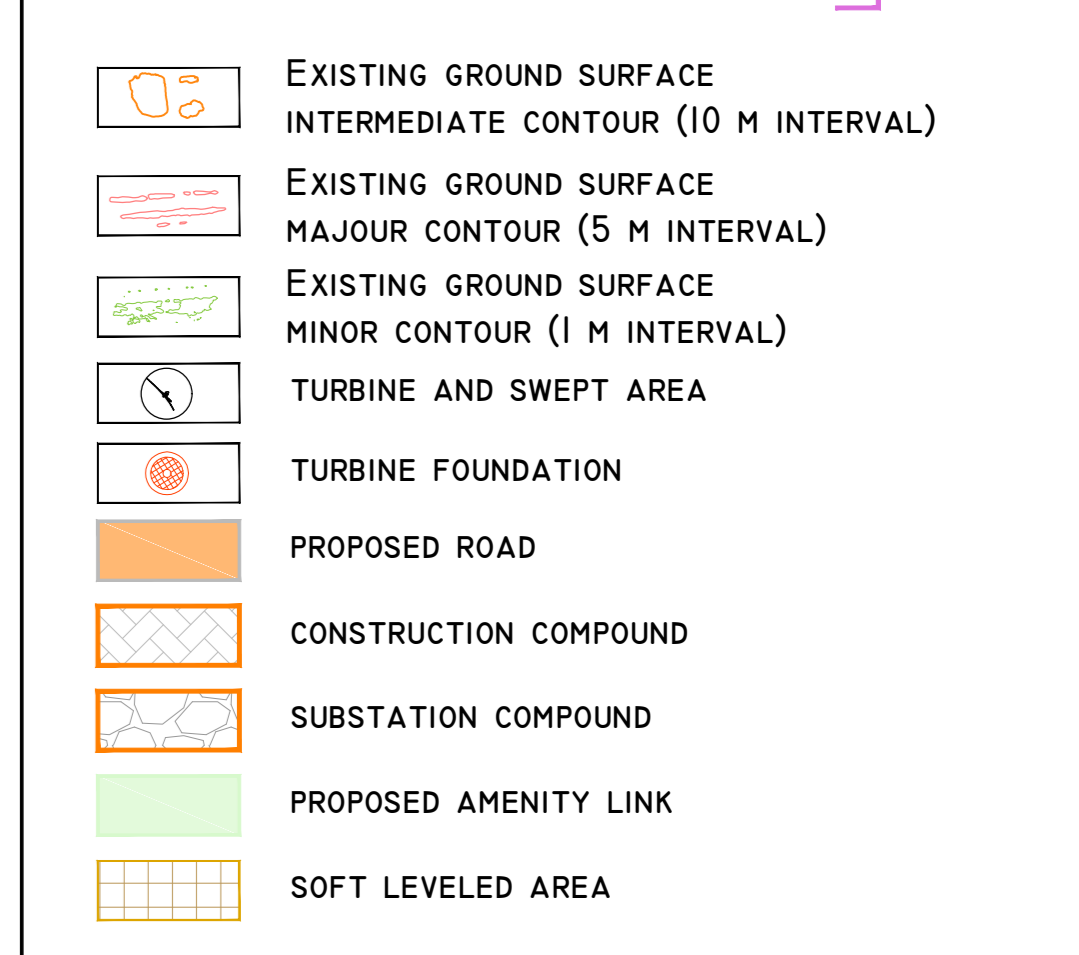
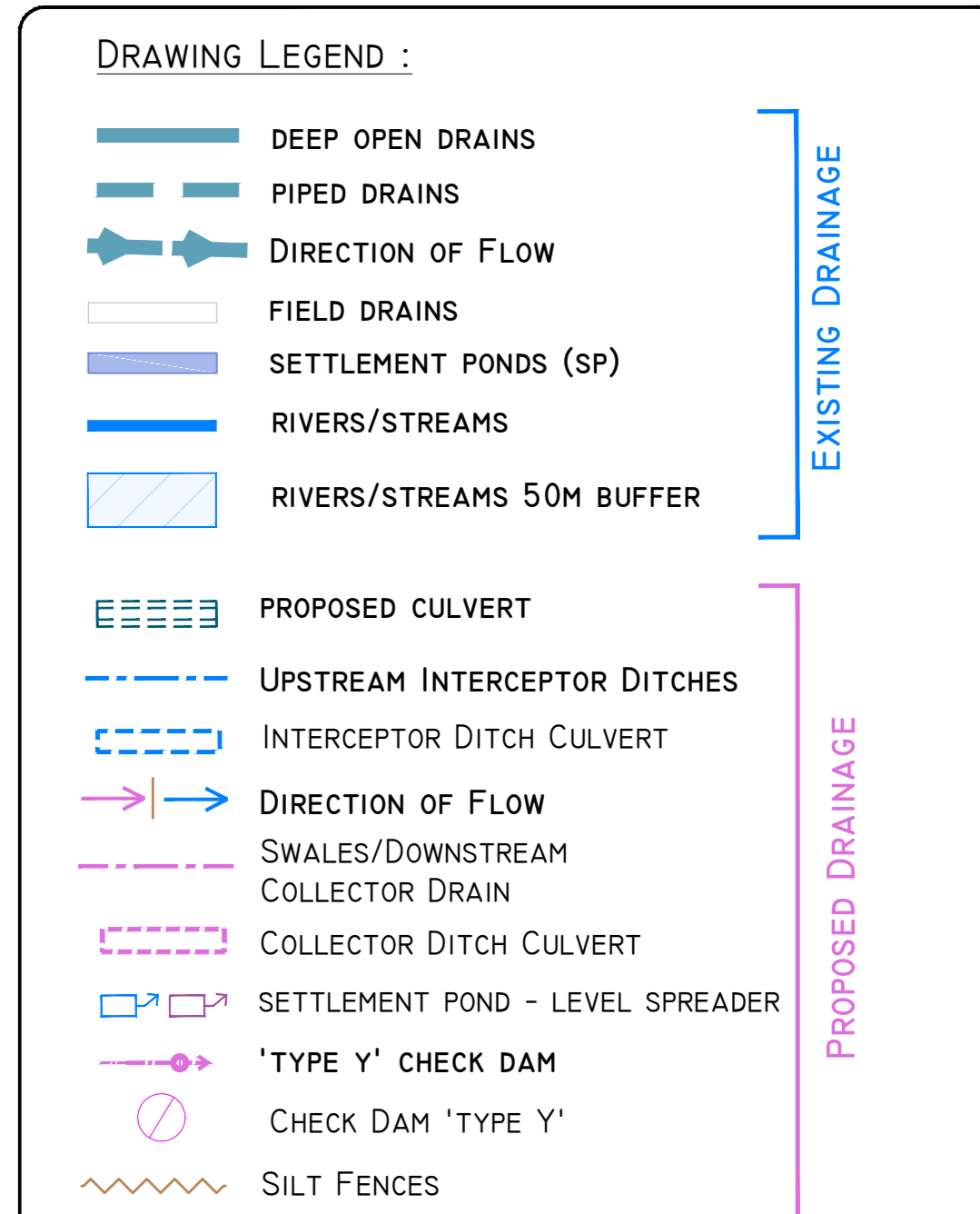
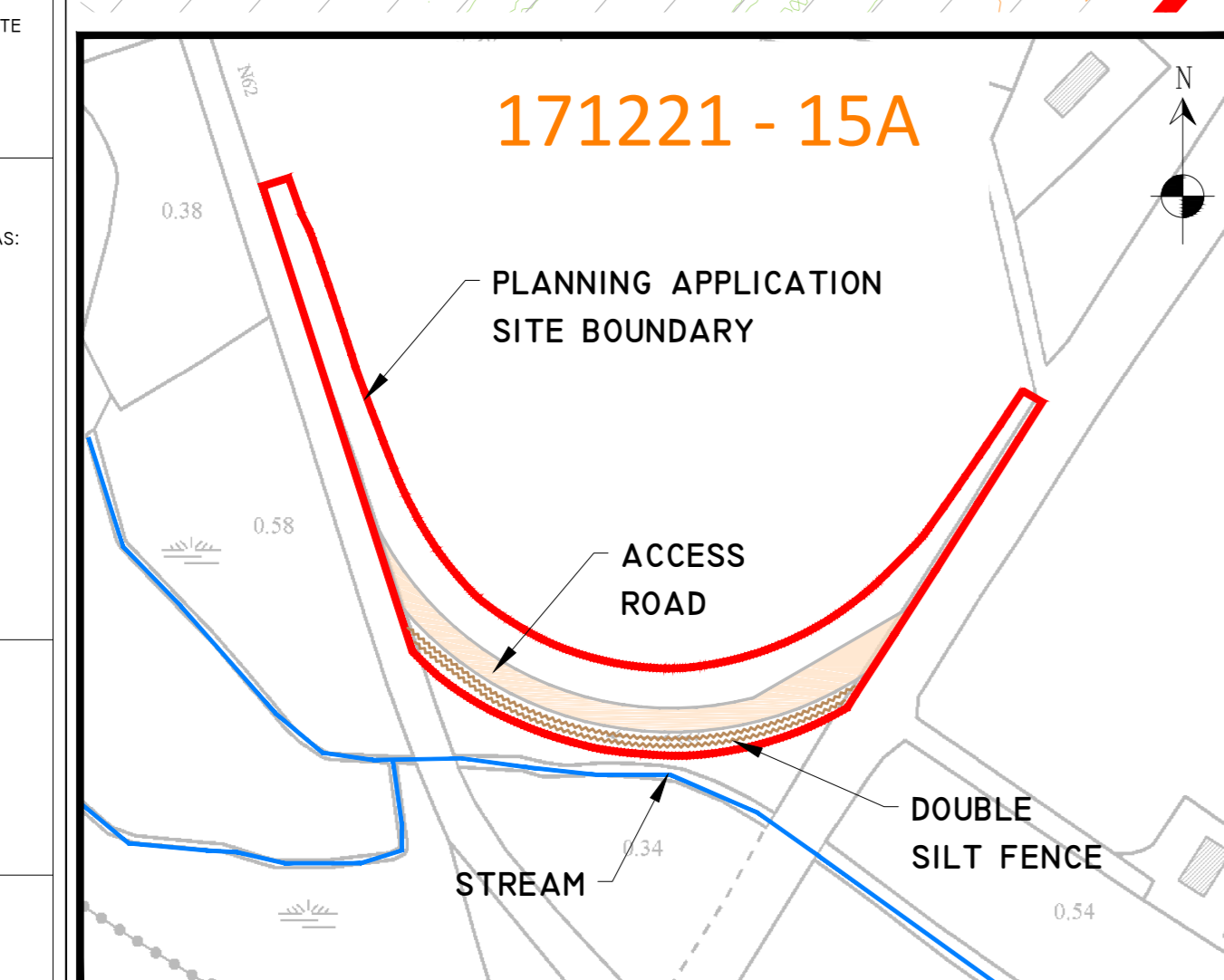
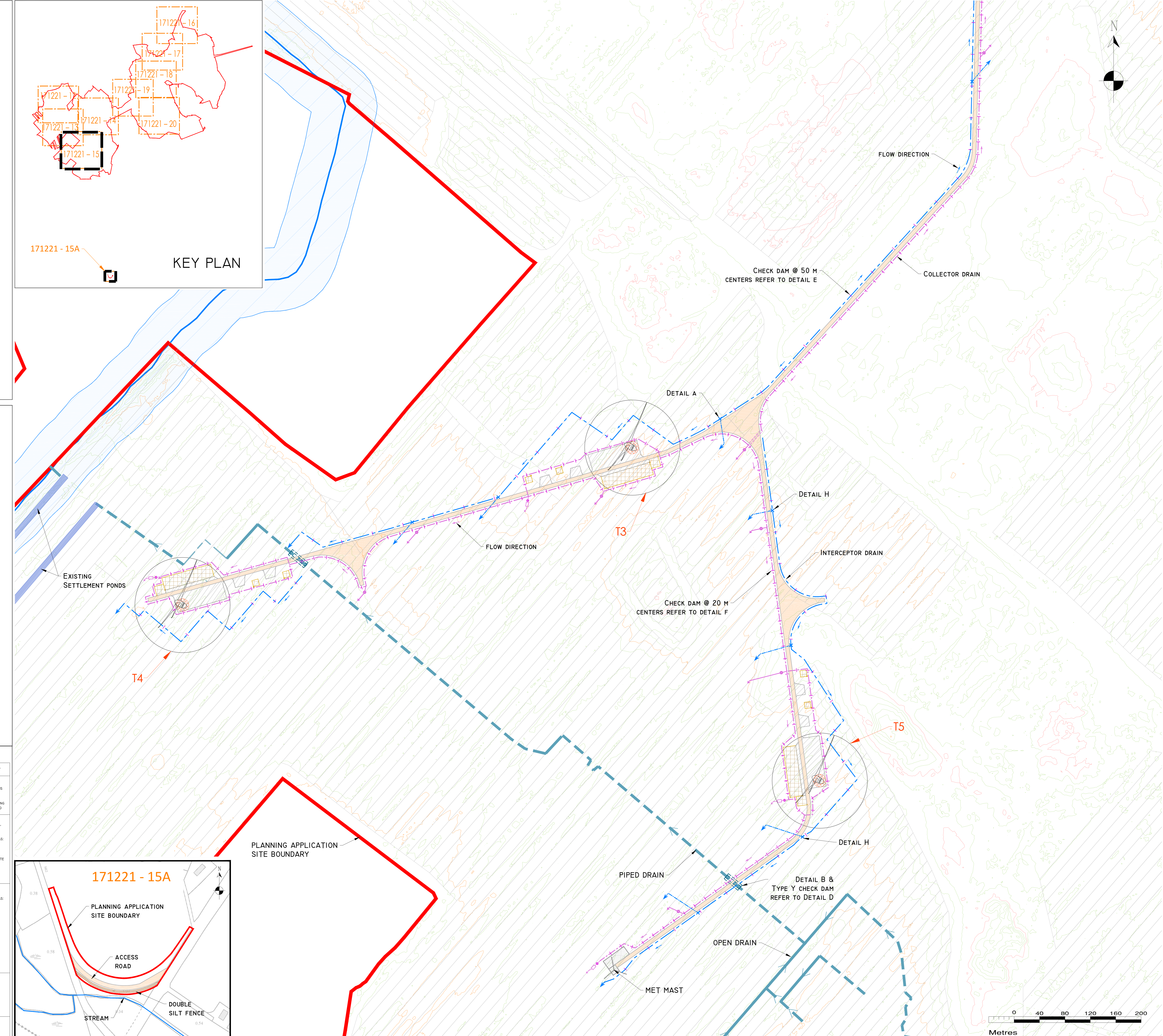

DRAWING NOTES

1. DRAWINGS ISSUED ARE FOR PLANNING APPLICATION PURPOSES ONLY.
2. COPYRIGHT, ALL RIGHTS RESERVED. NO PART HERE WITH MAY BE COPIED OR REPRODUCED PARTIALLY OR WHOLLY IN ANY FORM WHATSOEVER WITHOUT THE PRIOR NOTICE OF THE COPYRIGHT OWNER HYDRO-ENVIRONMENTAL SERVICES.
3. DO NOT SCALE OFF THIS DRAWING. FIGURED METRIC DIMENSIONS ONLY SHOULD BE TAKEN OFF THIS DRAWING.
4. ALL DIMENSIONS ARE IN METRES.

Ordnance Survey Ireland Licence No. EN 0044720
© Ordnance Survey Ireland/Government of Ireland

Date	Description	Chkd	Signed
Revisions			

HYDRO ENVIRONMENTAL SERVICES

22 Lower Main St
Dungarvan
Co. Waterford
Ireland

tel: +353 (0) 58-44122
tel: +353 (0) 58-44244
email: info@hydroenvironmental.ie
web: www.hydroenvironmental.ie

Client: **BORD NA MONA POWERGEN LTD**

Job: **DERRINLOUGH WF, CO. OFFALY**

Title: **PROPOSED DRAINAGE LAYOUT**

Figure No: **171221 - 15**

Drawing No: P1463-0-0220-A0-171221-15-00A

Sheet Size: A0 Project No.: P1463-0

Scale: 1:2,000 (A0) Drawn By: MG / GD

Date: 14/02/2020 Checked By: MG

